

-20°C ÷ +110°C  
Subject to applications



**Working pressure:**  
14 Bar (at 20°C)  
Depending on the tube used



Compressed air, water and fluids suitable with construction materials



- Taper gas BSPT ISO 7  
from R1/8" to R3/4"  
- NPT  
from N1/8" to N3/4"



Body: Nylon 66

### FEATURES

The fittings of this series have plastic thread and consequently we recommend to avoid excessive force during screwing and to teflon the thread before use in order to prevent any type of loss.



Food contact materials  
EC 1935/2004



D.M. 174/2004



Products in compliance with  
EC Regulation 1907/2006



Products in compliance with  
the directive EU 2015/863

### CONSTRUCTION DETAILS

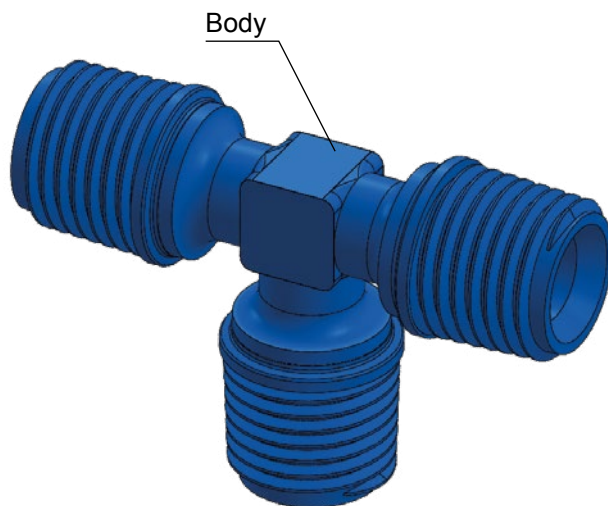

### TIGHTENING TORQUE TAPER GAS BSPT ISO 7

THREAD	1/8"	1/4"	3/8"	1/2"	3/4"
Nm	0,1	0,8	4	6	8



**1800**

Nipple BSPT thread

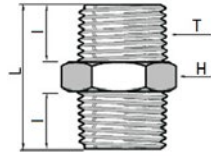

CODE	T	L	I	H	g
1800TR18	R 1/8"	23,2	8,0	11	1,4
1800TR14	R 1/4"	27,1	10,0	14	3,5
1800TR38	R 3/8"	28,2	10,0	17	4,2
1800TR12	R 1/2"	34,1	12,5	22	8,0
1800TR34	R 3/4"	36,0	-	27	-

**1802**

Reduced nipple BSPT thread

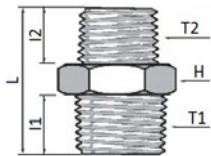

CODE	T1	T2	I1	I2	L	H	g
1802TR1418	R 1/4"	R 1/8"	10,5	8,5	25,2	14	2,5
1802TR3818	R 3/8"	R 1/8"	10,0	8,0	27,1	17	3,8
1802TR3814	R 3/8"	R 1/4"	10,0	10,0	28,5	17	4,1
1802TR1214	R 1/2"	R 1/4"	13,0	10,5	31,5	22	6,7
1802TR1238	R 1/2"	R 3/8"	13,0	10,5	31,5	22	6,0
1802TR3412	R 3/4"	R 1/2"	-	-	34,5	27	-

**1810**

Male elbow BSPT thread

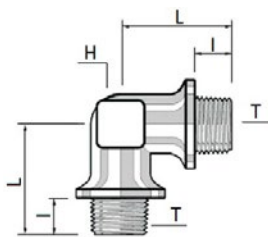

CODE	T	I	L	H	g
1810TR18	R 1/8"	8,0	20,0	10	3,0
1810TR14	R 1/4"	10,0	22,0	10	4,0
1810TR38	R 3/8"	10,0	24,0	14	7,0
1810TR12	R 1/2"	12,5	32,0	17	15,0

**1812**

Reduced male elbow BSPT thread

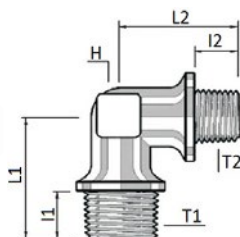

CODE	T1	T2	I1	I2	L1	L2	H	g
1812TR1418	R 1/4"	R 1/8"	10,0	8,0	22,0	20,0	12	3,6
1812TR3814	R 3/8"	R 1/4"	10,0	10,0	24,0	24,0	15	6,5
1812TR1238	R 1/2"	R 3/8"	12,5	10,0	32,0	29,5	17	13,0



**1820**

Adapter M/F BSPT thread

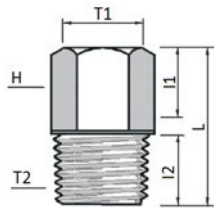

CODE	T1	T2	I1	I2	L	H	g
1820TR1818	R 1/8"	R 1/8"	9,0	8,0	23,0	14	1,0
1820TR1414	R 1/4"	R 1/4"	10,5	10,0	24,0	17	3,0
1820TR3838	R 3/8"	R 3/8"	11,0	10,5	25,7	22	5,3
1820TR1212	R 1/2"	R 1/2"	13,5	13,0	30,6	26	9,0

REDUCED ADAPTER M/F BSPT THREAD

1820TR1814	R 1/8"	R 1/4"	10,5	10,0	23,0	14	2,4
1820TR1838	R 1/8"	R 3/8"	9,0	10,0	24,0	14	2,7
1820TR1812	R 1/8"	R 1/2"	9,0	12,0	27,0	14	4,1
1820TR1438	R 1/4"	R 3/8"	10,5	10,0	24,8	17	5,0
1820TR1412	R 1/4"	R 1/2"	10,5	10,0	27,2	17	4,8
1820TR3812	R 3/8"	R 1/2"	11,0	13,0	28,2	22	8,0

ENLARGER ADAPTER M/F BSPT THREAD

1820TR1418	R 1/4"	R 1/8"	10,5	8,0	22,1	17	2,8
1820TR3818	R 3/8"	R 1/8"	11,0	8,0	23,1	22	4,8
1820TR3814	R 3/8"	R 1/4"	11,0	10,0	25,2	22	5,1
1820TR1218	R 1/2"	R 1/8"	13,5	8,0	25,6	26	7,0
1820TR1214	R 1/2"	R 1/4"	13,5	10,0	27,3	26	7,2
1820TR1238	R 1/2"	R 3/8"	13,5	10,0	28,0	26	8,0

**1825**

Female sleeve BSPT thread

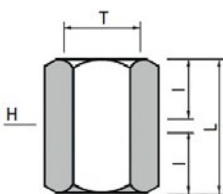

CODE	T	I	L	H	g
1825TR18	R 1/8"	9,0	20,0	14	2,3
1825TR14	R 1/4"	11,0	23,6	17	3,7
1825TR38	R 3/8"	11,0	24,5	21	5,2
1825TR12	R 1/2"	13,5	29,7	26	9,6
1825TR34	R 3/4"	18,0	38,0	34	16,8

**1827**

Reduced female sleeve BSPT thread

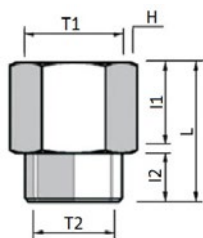

CODE	T1	T2	I1	I2	L	H	g
1827TR1418	R 1/4"	R 1/8"	11,0	9,0	22,0	17	3,2
1827TR3818	R 3/8"	R 1/8"	11,0	9,0	24,5	21	5,2
1827TR3814	R 3/8"	R 1/4"	11,0	11,0	24,5	21	6,0
1827TR1214	R 1/2"	R 1/4"	13,5	11,0	27,0	26	8,0
1827TR1238	R 1/2"	R 3/8"	13,5	11,0	27,0	26	7,7
1827TR3414	R 3/4"	R 1/4"	13,5	11,0	30,1	34	11,0
1827TR3412	R 3/4"	R 1/2"	13,5	11,0	35,0	34	14,5



## 1830

## Male tee BSPT thread

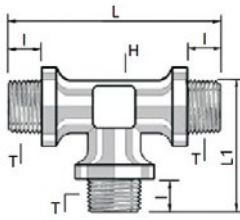

CODE	T	I	L	L1	H	g
1830TR18	R 1/8"	8,0	39,8	24,1	12	4,0
1830TR14	R 1/4"	10,0	44,0	26,2	12	5,0
1830TR38	R 3/8"	10,0	50,5	32,0	15	10,0
1830TR12	R 1/2"	12,5	64,0	40,3	17	22,0

## 1832

## Reduced male tee BSPT thread

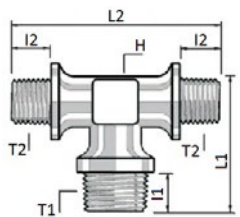

CODE	T1	T2	I1	I2	L1	L2	H	g
1832TR1814	R 1/8"	R 1/4"	8,0	10,0	26,4	39,7	12	4,4
1832TR1438	R 1/4"	R 3/8"	10,0	10,0	38,2	43,3	15	9,3
1832TR3812	R 3/8"	R 1/2"	10,0	12,5	40,4	60,2	17	17,3
ENLARGER MALE TEE BSPT THREAD								
1832TR1418	R 1/4"	R 1/8"	10,0	8,0	24,2	43,3	12	5,6
1832TR3814	R 3/8"	R 1/4"	10,0	10,0	26,4	60,2	15	9,7
1832TR1238	R 1/2"	R 3/8"	12,5	10,0	38,2	64,2	17	17,0

## 1834

## Lateral reduced male tee BSPT thread

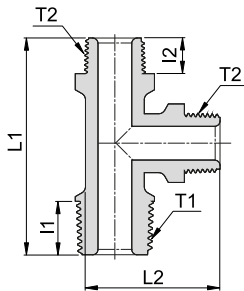

CODE	T1	T2	I1	I2	L1	L2	g
1834TR1814	R 1/8"	R 1/4"	8,0	10,0	42,7	25,5	5,0
1834TR1438	R 1/4"	R 3/8"	10,0	10,0	48,5	31,0	9,5
1834TR3812	R 3/8"	R 1/2"	10,0	12,5	62,0	38,2	19,0
LATERAL ENLARGER MALE TEE BSPT THREAD							
1834TR1418	R 1/4"	R 1/8"	10,0	8,0	41,8	26,3	4,9
1834TR3814	R 3/8"	R 1/4"	10,0	10,0	48,3	30,8	8,8
1834TR1238	R 1/2"	R 3/8"	12,5	10,0	62,0	40,0	17,9

## 1840

## M/F reducer BSPT thread

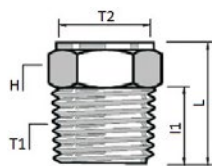

CODE	T1	T2	I1	L	H	g
1840TR1418	R 1/4"	R 1/8"	10,0	17,2	14	1,5
1840TR3818	R 3/8"	R 1/8"	10,5	17,8	17	2,7
1840TR3814	R 3/8"	R 1/4"	10,5	17,8	17	2,1
1840TR1218	R 1/2"	R 1/8"	12,5	20,7	22	6,0
1840TR1214	R 1/2"	R 1/4"	12,5	20,4	22	5,5
1840TR1238	R 1/2"	R 3/8"	12,5	20,7	22	3,8
1840TR3414	R 3/4"	R 1/4"	13,5	22,0	27	8,9
1840TR3438	R 3/4"	R 3/8"	13,5	22,2	27	8,1
1840TR3412	R 3/4"	R 1/2"	13,5	22,4	27	7,0



## 1850

## Male plug BSPT thread

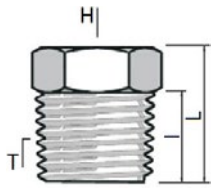

CODE	T	I	L	H	g
1850TR18	R 1/8"	9,0	13,6	11	1,0
1850TR14	R 1/4"	10,5	16,6	14	2,0
1850TR38	R 3/8"	10,5	16,1	17	3,0
1850TR12	R 1/2"	12,5	19,6	22	5,0
1850TR34	R 3/4"	15,0	22,0	27	8,0
1850TR1	R 1"	20,0	27,0	36	-

## 1855

## Female plug BSPT thread

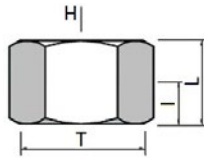

CODE	T	I	L	H	g
1855TR18	R 1/8"	9,0	10,4	13	1,1
1855TR14	R 1/4"	10,0	14,2	17	1,2
1855TR38	R 3/8"	11,0	14,2	20	2,7
1855TR12	R 1/2"	13,5	17,1	24	4,3
1855TR34	R 3/4"	14,0	17,1	30	6,2

## 1875

## Nut BSPT thread

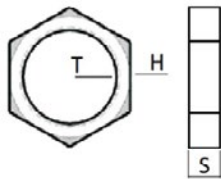

CODE	T	S	H	g	COLOURS
1875TR14	G 1/4"	5,0	17	1,1	BLACK
1875TR12	G 1/2"	11,6	26	1,2	BLUE



**1800N**

Nipple NPT thread

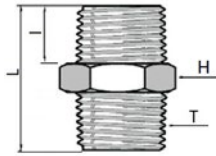

CODE	T	I	H	g
1800TRN18	N 1/8"	11	23,9	1,4
1800TRN14	N 1/4"	14	32,7	2,79
1800TRN38	N 3/8"	17	34,4	4,85
1800TRN12	N 1/2"	22	43,3	8,75
1800TRN34	N 3/4"	27	44,4	12,44

**1802N**

Reduced nipple NPT thread

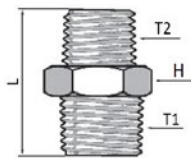

CODE	T1	T2	H	L	g
1802TRN1418	N 1/4"	N 1/8"	14	28,4	2,3
1802TRN3818	N 3/8"	N 1/8"	17	29,6	3,8
1802TRN1218	N 1/2"	N 1/8"	22	34,9	6,4
1802TRN3418	N 3/4"	N 1/8"	27	35,4	9,1
1802TRN3814	N 3/8"	N 1/4"	17	33,4	4,17
1802TRN1214	N 1/2"	N 1/4"	22	38,7	6,9
1802TRN3414	N 3/4"	N 1/4"	27	39,4	9,5
1802TRN1238	N 1/2"	N 3/8"	22	39,1	7,6
1802TRN3438	N 3/4"	N 3/8"	27	39,6	10,2
1802TRN3412	N 3/4"	N 1/2"	27	44,1	11,4

**1810N**

Male elbow NPT thread

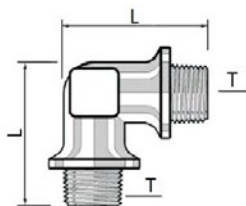

CODE	T	L	g
1810TRN18	N 1/8"	23,8	2,2
1810TRN14	N 1/4"	28,4	3,3

**1812N**

Reduced male elbow NPT thread

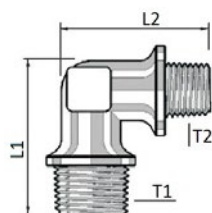

CODE	T1	T2	L1	L2	g
1812TRN1418	N 1/4"	N 1/8"	28,4	24,0	2,9



**1820N**

## M/F adapter NPT thread

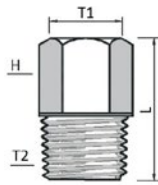

CODE	T1	T2	H	L	g
1820TRN1818	N 1/8"	N 1/8"	14	23,4	2,2
1820TRN1414	N 1/4"	N 1/4"	17	30,7	3,8
1820TRN3838	N 3/8"	N 3/8"	22	30,4	5,95
1820TRN1212	N 1/2"	N 1/2"	26	39,0	5,77

## REDUCED M/F ADAPTER NPT THREAD

1820TRN1814	N 1/8"	N 1/4"	14	23,4	2,55
1820TRN1838	N 1/8"	N 3/8"	14	27,4	3,13
1820TRN1812	N 1/8"	N 1/2"	14	32,5	4,66
1820TRN1438	N 1/4"	N 3/8"	17	30,5	4,23
1820TRN1412	N 1/4"	N 1/2"	17	35,5	5,8
1820TRN3812	N 3/8"	N 1/2"	22	35,5	7,66

## ENLARGER M/F ADAPTER NPT THREAD

1820TRN1418	N 1/4"	N 1/8"	17	26,5	3,17
1820TRN3818	N 3/8"	N 1/8"	22	26,3	5,06
1820TRN3814	N 3/8"	N 1/4"	22	26,5	5,68
1820TRN1218	N 1/2"	N 1/8"	26	30,0	7,73
1820TRN1214	N 1/2"	N 1/4"	26	34,0	8,04
1820TRN1238	N 1/2"	N 3/8"	26	36,6	8,66

**1825N**

## Female sleeve NPT thread

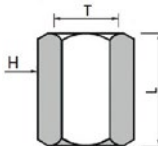

CODE	T	H	L	g
1825TRN18	N 1/8"	14	19,7	2,3
1825TRN14	N 1/4"	17	23,5	3,7
1825TRN38	N 3/8"	22	24,6	5,2
1825TRN12	N 1/2"	27	29,5	9,7

**1827N**

## Reduced female sleeve NPT thread

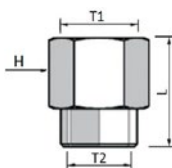

CODE	T1	T2	H	L	g
1827TRN1418	N 1/4"	N 1/8"	17	22,0	3,2
1827TRN3818	N 3/8"	N 1/8"	22	24,4	4,9
1827TRN3814	N 3/8"	N 1/4"	22	24,8	4,83
1827TRN1214	N 1/2"	N 1/4"	26	27,0	7,4
1827TRN1238	N 1/2"	N 3/8"	26	26,8	7,8



**1830N**

Male tee NPT thread

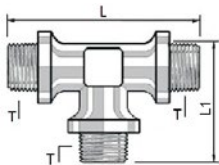

CODE	T	L	L1	g
1830TRN18	N 1/8"	39,3	24,0	3,2
1830TRN14	N 1/4"	48,4	28,5	4,8

**1832N**

Reduced male tee NPT thread

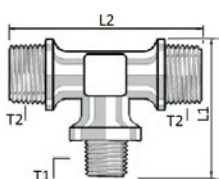

CODE	T1	T2	L1	L2	g
1832TRN1418	N 1/8"	N 1/4"	48,4	24,0	4,2

**1840N**

M/F reduced NPT thread

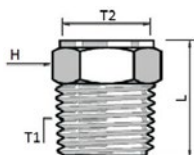

CODE	T1	T2	H	L	g
1840TRN1418	N 1/4"	N 1/8"	15	21,0	1,78
1840TRN3818	N 3/8"	N 1/8"	18	20,8	3,3
1840TRN3814	N 3/8"	N 1/4"	19	20,8	2,4
1840TRN1218	N 1/2"	N 1/8"	24	27,2	6,98
1840TRN1214	N 1/2"	N 1/4"	19	27,1	6,65
1840TRN1238	N 1/2"	N 3/8"	29	27,2	5,55
1840TRN3414	N 3/4"	N 1/4"	29	27,0	10,44
1840TRN3438	N 3/4"	N 3/8"	29	27,2	9,85
1840TRN3412	N 3/4"	N 1/2"	29	27,3	7,9

**1850N**

Male plug NPT thread

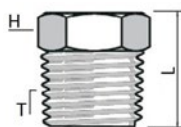

CODE	T	H	L	g
1850TRN18	N 1/8"	11	14,7	1,1
1850TRN14	N 1/4"	14	19,4	2
1850TRN38	N 3/8"	17	20,4	3,3
1850TRN12	N 1/2"	22	25,6	6
1850TRN34	N 3/4"	27	26,0	8,7

