

0°C ÷ +80°C

**Working pressure:**  
form 60 to 100 Bar



For each size, the pressure is a function of the tube quality, condition, thickness and maximum using temperature. Mechanical constraints reduce the level of pressure application.



Compressed air, water and fluids suitable with construction materials



- Taper gas BSPT ISO 7  
from R1/8" to R1"  
- Parallel gas BSPP ISO 228  
from G1/8" to G1"



**Metal tubes:** brass, copper  
**Plastic tubes:** push-lock hoses  
ASR, ASR-HH and ASR-PU used  
with fittings 3467 and 3468

**Body:** Turning - yellow brass  
UNI EN 12164 CW 614N

Hot forging & machining - yellow brass  
UNI EN12165 CW 617N



**Lock nut:** Yellow brass  
UNI EN 12164 CW 614N

**Ogive:** Yellow brass  
UNI EN 12164 CW 614N

**Seal:** Metal-nitrile



Products in compliance with  
EC Regulation 1907/2006



Products in compliance with  
the directive EU 2015/863

### ASSEMBLY INSTRUCTIONS FOR HARD TUBES

- Cut the tube and remove the internal and external burrs
- Insert the nut into the tube and lubricate the thread
- Assemble the ogive on the final part of the tube
- Push the tube into the fitting until it stops
- Thanks to the ogive grip it is possible to screw the lubricated nut until the tube is fixed

### CONSTRUCTION DETAILS

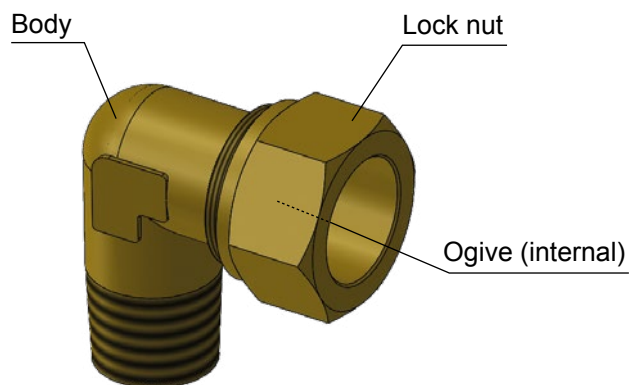

### TIGHTENING TORQUE

#### LOCK NUT FOR HARD TUBES

Ø TUBE	4	6	8	10	12	14	16	18	20	22	28
Nm	7,8	15,7	15,7	18,5	29,4	34,3	49	58,8	58,8	68,6	88,2



3400

Male connector BSPT thread

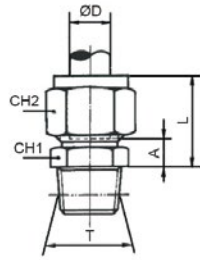

CODE	ØD	T	A	L	CH1	CH2	g
3400TR184	4	R 1/8"	7,0	17,0	10	10	13,0
3400TR144		R 1/4"	9,5	20,0	14	10	-
3400TR186	6	R 1/8"	7,5	18,0	11	13	18,0
3400TR146		R 1/4"	7,5	18,0	14	13	25,0
3400TR386		R 3/8"	8,5	19,0	17	13	-
3400TR188	8	R 1/8"	7,0	19,5	13	14	22,0
3400TR148		R 1/4"	7,0	19,5	14	14	27,0
3400TR388		R 3/8"	8,0	20,5	17	14	33,0
3400TR1810	10	R 1/8"	9,0	24,0	17	19	-
3400TR1410		R 1/4"	9,0	24,0	17	19	48,0
3400TR3810		R 3/8"	9,0	24,0	17	19	49,0
3400TR1210		R 1/2"	10,0	25,0	22	19	67,0
3400TR1412	12	R 1/4"	9,0	24,0	19	22	57,5
3400TR3812		R 3/8"	9,0	24,0	19	22	-
3400TR1212		R 1/2"	10,0	25,0	22	22	-
3400TR1414	14	R 1/4"	10,5	26,0	22	24	-
3400TR3814		R 3/8"	8,0	25,0	22	24	70,0
3400TR1214		R 1/2"	9,0	26,0	22	24	80,0
3400TR1216	16	R 1/2"	9,5	27,0	24	27	101,0
3400TR3416		R 3/4"	10,5	28,0	27	27	-
3400TR1218	18	R 1/2"	10,5	30,0	27	30	132,0
3400TR3418		R 3/4"	10,5	30,0	27	30	143,0
3400TR1220	20	R 1/2"	11,0	32,0	30	32	-
3400TR1222	22	R 1/2"	11,0	33,0	32	36	187,0
3400TR3422		R 3/4"	11,0	33,0	32	36	195,0
3400TR122		R 1"	11,0	33,0	36	36	225,0



## 3422

## Male connector BSPP thread with seal

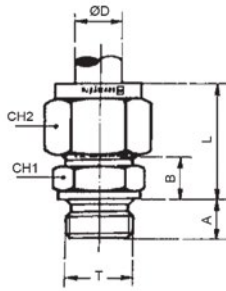

CODE	ØD	T	A	B	L	CH1	CH2	g
3422TR184	4	G 1/8"	6,5	8,0	16,5	13	10	-
3422TR186	6	G 1/8"	6,5	8,5	18,0	13	13	-
3422TR146		G 1/4"	8,0	9,5	18,0	17	13	-
3422TR188	8	G 1/8"	6,5	8,5	19,0	13	14	-
3422TR148		G 1/4"	8,0	9,0	19,5	17	14	-
3422TR388		G 3/8"	10,8	11,0	24,5	22	14	-
3422TR1410	10	G 1/4"	8,0	11,0	24,0	17	19	47,5
3422TR3810		G 3/8"	11,0	11,5	24,0	22	19	65,5
3422TR1412	12	G 1/4"	8,0	11,0	24,0	19	22	59,5
3422TR3814	14	G 3/8"	11,0	10,5	25,0	22	24	-
3422TR1214		G 1/2"	12,0	11,0	25,0	27	24	97,0
3422TR3816	16	G 3/8"	11,0	12,0	27,0	22	27	-
3422TR1216		G 1/2"	12,0	12,5	27,0	27	27	-
3422TR1218	18	G 3/8"	12,0	12,5	29,5	27	30	-
3422TR3418		G 3/4"	13,0	13,0	29,5	32	30	-
3422TR3422	22	G 3/4"	13,0	13,0	32,0	32	36	-
3422TR122		G 1"	15,0	13,5	32,0	41	36	-
3422TR128	28	G 1"	15,0	13,5	35,5	41	42	-

## 3430

## Female connector BSPP thread

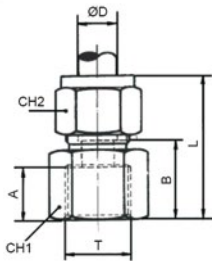

CODE	ØD	T	A	B	L	CH1	CH2	g
3430TR184	4	G 1/8"	9,5	16,5	26	14	10	-
3430TR144		G 1/4"	13,5	20,5	30	17	10	-
3430TR186	6	G 1/8"	9,5	17,0	28	14	13	26,0
3430TR146		G 1/4"	13,5	21,0	32	17	13	35,0
3430TR188	8	G 1/8"	9,5	16,5	29	14	14	28,0
3430TR148		G 1/4"	13,5	20,5	33	17	14	36,0
3430TR388		G 3/8"	14,0	21,0	34	22	14	53,0
3430TR1410	10	G 1/4"	13,5	21,5	37	17	19	52,0
3430TR3810		G 3/8"	14,0	22,0	37	22	19	70,0
3430TR1210	12	G 1/2"	18,5	26,5	42	27	19	102,0
3430TR3814	14	G 3/8"	14,0	21,0	38	22	24	82,0
3430TR1214		G 1/2"	18,5	25,5	43	27	24	113,0
3430TR1216	16	G 1/2"	18,5	26,0	44	27	27	-
3430TR1218	18	G 1/2"	18,5	26,0	45	27	30	147,0
3430TR3418		G 3/4"	19,5	27,0	46	32	30	169,0
3430TR3422	22	G 3/4"	19,5	26,5	48	32	36	205,0



**3440**

Male elbow BSPT thread

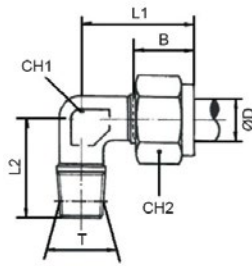

CODE	ØD	T	B	L1	L2	CH1	CH2	g
3440TR184	4	R 1/8"	12,0	19,0	17,0	8	10	-
3440TR144		R 1/4"	12,0	19,0	20,0	10	10	-
3440TR186	6	R 1/8"	13,0	22,0	18,0	8	13	22,0
3440TR146		R 1/4"	13,0	22,0	21,5	10	13	31,0
3440TR188	8	R 1/8"	15,0	28,0	18,5	10	14	29,0
3440TR148		R 1/4"	15,0	28,0	22,0	10	14	34,0
3440TR388		R 3/8"	15,0	28,0	24,0	12	14	45,0
3440TR1410	10	R 1/4"	17,0	30,0	25,0	12	19	53,0
3440TR3810		R 3/8"	17,0	30,0	25,5	12	19	62,0
3440TR1210		R 1/2"	17,0	36,0	32,0	19	19	107,0
3440TR1412	12	R 1/4"	18,0	30,0	26,0	15	22	-
3440TR3812		R 3/8"	18,0	30,0	27,0	15	22	-
3440TR1212		R 1/2"	18,0	36,0	32,0	19	22	-
3440TR3814	14	R 3/8"	18,0	35,0	30,0	19	24	105,0
3440TR1214		R 1/2"	18,0	35,0	32,0	19	24	109,0
3440TR3816		R 3/8"	21,0	39,0	30,0	19	27	-
3440TR1216	16	R 1/2"	21,0	39,0	33,5	19	27	135,0
3440TR3416		R 3/4"	21,0	41,0	36,5	23	27	-
3440TR1218	18	R 1/2"	21,5	41,0	35,5	23	30	176,0
3440TR3418		R 3/4"	21,5	41,0	36,5	23	30	203,0
3440TR3420	20	R 3/4"	21,5	42,0	38,0	23	32	-
3440TR3422	22	R 3/4"	25,0	50,0	40,0	27	36	296,0
3440TR122		R 1"	25,0	50,0	44,0	27	36	324,0

**3442**

Swivel male elbow BSPP thread with seal

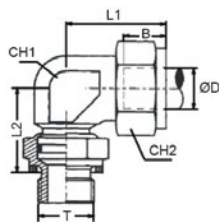

CODE	ØD	T	B	L1	L2	CH1	CH2	g
3442TR184	4	G 1/8"	12,0	19,0	16,0	8	10	21,5
3442TR144		G 1/4"	12,0	19,0	22,0	10	10	-
3442TR186	6	G 1/8"	13,0	22,0	16,0	8	13	23,0
3442TR146		G 1/4"	13,0	22,0	22,0	10	13	31,0
3442TR188	8	G 1/8"	15,0	28,0	18,5	10	14	29,0
3442TR148		G 1/4"	15,0	28,0	22,0	10	14	34,0
3442TR388		G 3/8"	15,0	28,0	24,0	12	14	43,0
3442TR1410	10	G 1/4"	17,0	30,0	22,0	12	19	53,0
3442TR3810		G 3/8"	17,0	30,0	24,0	12	19	64,0
3442TR1210		G 1/2"	17,0	30,0	29,5	19	19	102,0
3442TR3814	14	G 3/8"	18,0	35,0	25,0	19	24	105,0
3442TR1214		G 1/2"	18,0	35,0	29,5	19	24	108,0
3442TR1218	18	G 1/2"	21,0	41,0	30,5	23	30	174,0
3442TR3418		G 3/4"	21,5	41,0	32,8	23	30	202,0
3442TR122	22	G 1"	25,0	50,0	43,5	27	36	323,0
3442TR128	28	G 1"	30,0	54,0	43,5	32	42	-



## 3460

## Male tee BSPT thread

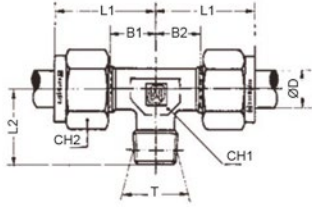

CODE	ØD	T	B1	B2	L1	L2	CH1	CH2	g
3460TR184	4	R 1/8"	9,5	9,5	19,0	17,0	8	10	-
3460TR185	5	R 1/8"	11,0	11,0	21,0	17,5	8	12	-
3460TR186	6	R 1/8"	11,0	11,0	22,0	18,0	8	13	-
3460TR146		R 1/4"	16,0	16,0	27,0	21,5	10	13	-
3460TR188	8	R 1/8"	15,0	15,0	28,0	18,5	10	14	-
3460TR148		R 1/4"	15,0	15,0	28,0	22,0	10	14	-
3460TR1410	10	R 1/4"	14,5	14,5	30,0	25,0	12	19	-
3460TR3810		R 3/8"	14,5	14,5	30,0	25,5	12	19	-
3460TR3812	12	R 3/8"	15,0	15,0	30,0	27,0	15	22	-
3460TR3814	14	R 3/8"	18,0	18,0	35,0	30,0	19	24	-
3460TR1214		R 1/2"	18,0	18,0	35,0	32,0	19	24	-
3460TR3815	15	R 3/8"	18,0	18,0	35,0	30,0	19	24	-
3460TR1215		R 1/2"	18,0	18,0	35,0	32,0	19	24	-
3460TR3816	16	R 3/8"	21,0	21,0	39,0	30,0	19	27	-
3460TR1216		R 1/2"	21,0	21,0	39,0	33,5	19	27	-

## 3465

## Swivel male tee BSPP thread

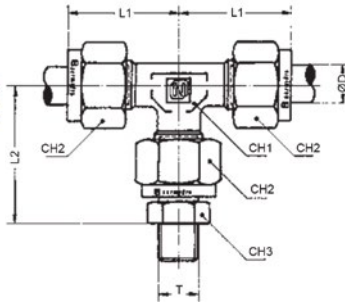

CODE	ØD	T	L1	L2	CH1	CH2	CH3	g
3465TR184	4	G 1/8"	19,0	25,0	8	10	13	-
3465TR144		G 1/4"	19,0	27,0	8	10	17	-
3465TR186	6	G 1/8"	22,0	28,0	8	13	13	-
3465TR146		G 1/4"	22,0	30,0	8	13	17	-
3465TR188	8	G 1/8"	28,0	34,0	10	14	13	-
3465TR148		G 1/4"	28,0	36,0	10	14	17	-
3465TR1410	10	G 1/4"	30,0	38,0	12	19	17	-
3465TR3810		G 3/8"	30,0	38,5	12	19	22	-
3465TR3814	14	G 3/8"	35,0	43,5	19	24	22	-
3465TR1214		G 1/2"	35,0	44,5	19	24	27	-
3465TR1218	18	G 1/2"	41,0	50,5	23	30	27	-
3465TR3418		G 3/4"	41,0	51,5	23	30	32	-
3465TR3422	22	G 3/4"	50,0	60,5	27	36	32	-
3465TR122		G 1"	50,0	61,0	27	36	41	-
3465TR128	28	G 1"	55,0	66,0	32	42	41	-



**3480**

Union connector

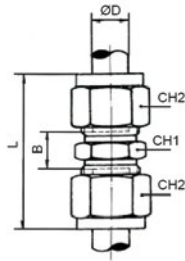

CODE	ØD	B	L	CH1	CH2	g
3480TR4	4	10,0	28,0	10	10	-
3480TR6	6	11,0	32,0	11	13	19,0
3480TR8	8	10,0	36,0	13	14	28,0
3480TR10	10	13,0	42,0	17	19	69,0
3480TR12	12	13,0	42,0	19	22	-
3480TR14	14	11,0	45,0	22	24	151,0
3480TR16	16	13,0	48,0	24	27	180,0
3480TR18	18	14,0	53,0	27	30	201,0
3480TR22	22	14,0	60,0	32	36	225,0
3480TR28	28	14,0	64,0	42	41	-

**3490**

Bulkhead connector

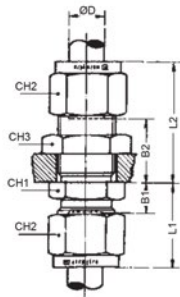

CODE	ØD	T	B1	B2	L1	L2	CH1	CH2	CH3	g
3490TR4	4	M8x1	7,0	17,0	17,0	27,0	10	10	13	-
3490TR6	6	M10x1	7,5	17,5	19,0	28,0	13	13	14	-
3490TR8	8	M12x1	7,0	17,0	20,0	29,0	14	14	17	-
3490TR10	10	M16x1,5	9,0	19,0	25,0	33,0	19	19	22	-
3490TR12	12	M18x1,5	9,0	19,0	25,0	33,0	22	22	22	-
3490TR14	14	M20x1,5	8,0	18,0	25,0	35,0	24	24	24	-
3490TR18	18	M24x1,5	10,5	20,5	30,0	40,0	27	30	30	-
3490TR22	22	M30x1,5	11,0	21,0	32,0	42,0	36	36	36	-
3490TR28	28	M36x1,5	19,0	30,0	40,0	52,0	42	42	42	-

**3500**

Union elbow

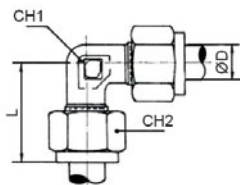

CODE	ØD	L	CH1	CH2	g
3500TR4	4	19,0	5	10	-
3500TR6	6	22,0	8	13	26,0
3500TR8	8	28,0	10	14	34,0
3500TR10	10	30,0	12	19	74,0
3500TR12	12	30,0	15	22	-
3500TR14	14	35,0	19	24	156,0
3500TR16	16	39,0	19	27	190,0
3500TR18	18	41,0	23	30	232,0
3500TR20	20	42,0	23	32	-
3500TR22	22	50,0	27	36	254,0
3500TR28	28	54,5	32	42	-



## 3510

## Union tee

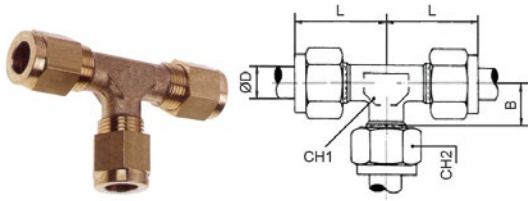

CODE	ØD	B	L	CH1	CH2	g
3510TR4	4	9,5	19,0	8	10	-
3510TR6	6	11,0	22,0	8	13	33,0
3510TR8	8	15,0	28,0	10	14	45,0
3510TR10	10	14,5	30,0	12	19	105,0
3510TR12	12	15,0	30,0	15	22	-
3510TR14	14	18,0	35,0	19	24	230,0
3510TR16	16	21,0	39,0	19	27	275,0
3510TR18	18	21,5	41,0	23	30	333,0
3510TR20	20	21,5	42,0	23	32	-
3510TR22	22	29,0	50,0	27	36	364,0
3510TR28	28	30,0	55,0	32	42	-

## 3520

## Union cross

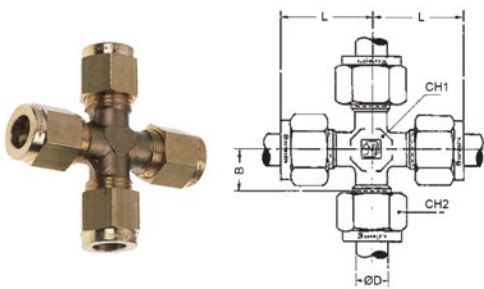

CODE	ØD	B	L	CH1	CH2	g
3520TR6	6	11,0	22,0	8	12	-
3520TR8	8	15,0	28,0	11	14	-
3520TR10	10	15,0	30,0	14	19	-
3520TR12	12	15,0	30,0	15	22	-
3520TR14	14	18,0	35,0	20	24	-
3520TR16	16	21,0	39,0	20	27	-
3520TR18	18	21,5	41,0	25	30	-
3520TR20	20	21,5	42,0	25	32	-
3520TR22	22	29,0	50,0	27	36	-

## 3530

## Locking nut

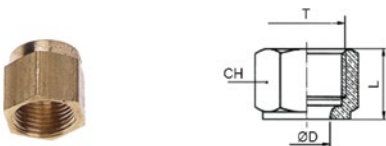

CODE	ØD	T	L	CH	g
3530TR4	4	M8X1	11,0	10	-
3530TR6	6	M10X1	11,0	13	5,4
3530TR8	8	M12X1	13,0	14	7,0
3530TR10	10	M16X1,5	15,0	19	18,2
3530TR12	12	M18X1,5	15,0	22	-
3530TR14	14	M20X1,5	15,0	24	44,3
3530TR16	16	M22X1,5	17,0	27	55,6
3530TR18	18	M24X1,5	18,0	30	64,2
3530TR20	20	M27X1,5	18,0	32	-
3530TR22	22	M30X1,5	19,0	36	76,3
3530TR28	28	M36X1,5	21,0	42	-



3540

Ogive

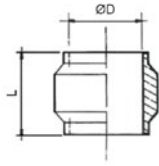

CODE	ØD	L	g
3540TR4	4	6,0	-
3540TR6	6	6,5	0,82
3540TR8	8	7,0	1,12
3540TR10	10	8,0	3,30
3540TR12	12	8,0	4,0
3540TR14	14	8,5	4,42
3540TR16	16	9,0	5,00
3540TR18	18	9,5	5,90
3540TR20	20	11,0	-
3540TR22	22	11,0	7,10
3540TR28	28	12,0	-

3560

Male adapter BSPT thread

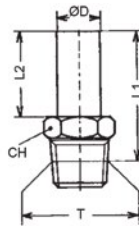

CODE	ØD	T	L1	L2	CH	g
3560TR186	6	R 1/8"	26,5	15	11	8,0
3560TR146		R 1/4"	31	15	14	-
3560TR188	8	R 1/8"	28,5	17	11	-
3560TR148		R 1/4"	33	17	14	-
3560TR388		R 3/8"	33,7	17	17	-
3560TR1410	10	R 1/4"	36	20	14	-
3560TR3810		R 3/8"	36,5	20	17	-
3560TR1210		R 1/2"	41	20	22	-
3560TR1412	12	R 1/4"	36	20	14	-
3560TR3812		R 3/8"	36,5	20	17	-
3560TR1212		R 1/2"	41	20	22	-
3560TR3814	14	R 3/8"	38	21,5	17	-
3560TR1214		R 1/2"	42,5	21,5	22	-
3560TR1216	16	R 1/2"	44	23	22	-
3560TR1218	18	R 1/2"	44,5	23,5	22	-
3560TR3418		R 3/4"	47,5	23,5	27	-
3560TR3422	22	R 3/4"	48,5	25,5	27	-





## 3572

## Male adapter BSPP thread

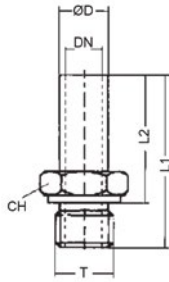

CODE	ØD	T	DN	L1	L2	CH	g
3572TR184	4	G 1/8"	2	25,5	19	13	-
3572TR186	6	G 1/8"	4	26,5	20	13	-
3572TR146		G 1/4"	4	30	22	17	22,0
3572TR188	8	G 1/8"	6	28,5	22	13	-
3572TR1410	10	G 1/4"	8	35	27	17	-
3572TR3810		G 3/8"	8	38,5	27,5	22	-
3572TR1210		G 1/2"	8	40,5	28,5	27	-
3572TR3814	14	G 3/8"	11	40	29	22	-
3572TR1214		G 1/2"	12	42	30	27	-
3572TR1218	18	G 1/2"	14	44	32	27	-
3572TR3418		G 3/4"	16	46	33	32	-
3572TR3422	22	G 3/4"	20	48	35	32	-
3572TR122		G 1"	20	50,5	35,5	41	-
3572TR128	28	G 1"	25	55	40	41	-

## 3467

## Male barb connector BSPP thread with metal-nitrile composite gasket

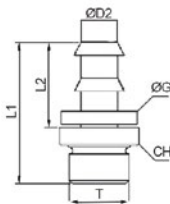

CODE	DN	T	ØD2	L1	L2	ØG	CH	g	
3467TR1814	1/4"	6	G 1/8"	4,0	31,5	20,0	14,0	13	14,0
3467TR1438	3/8"	10	G 1/4"	7,5	39,1	24,1	17,0	17	27,0
3467TR3838	3/8"	10	G 3/8"	7,5	42,5	24,1	17,0	22	47,0
3467TR3812	1/2"	13	G 3/8"	10,0	46,5	28,0	20,5	22	48,0
3467TR1212	1/2"	13	G 1/2"	10,0	48,5	28,0	20,5	27	79,0
3467TR1258	5/8"	16	G 1/2"	13,5	56,5	36,5	24,0	27	73,0
3467TR3434	3/4"	20	G 3/4"	16,0	65,3	43,0	27,0	32	123,0

3467: For use with our ASR, ASR-HH and ASR-PU tubes

## 2605

## Metal-nitrile composite gasket



CODE	2605TR18	2605TR14	2605TR38	2605TR12	2605TR34	2605TR1
THREAD	1/8"	1/4"	3/8"	1/2"	3/4"	1"



**3468**

Swivel female barb connector metric thread

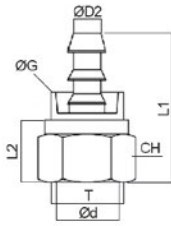

CODE	DN	T	ØD2	Ød	L1	L2	ØG	CH	g	
3468TRM1014	1/4"	6	M10x1	4,0	6	33,5	11,0	14,0	13	17,0
3468TRM1214	1/4"	6	M12x1	4,8	8	34,5	13,0	14,0	14	18,0
3468TRM1614	1/4"	6	M16x1,5	4,8	10	35,8	15,0	14,0	19	33,0
3468TRM1638	3/8"	10	M16x1,5	7,5	10	39,3	15,0	17,0	19	35,0
3468TRM2038	3/8"	10	M20x1,5	7,5	14	39,3	15,0	17,0	24	52,0
3468TRM2012	1/2"	13	M20x1,5	10,0	14	44,0	15,0	20,5	24	56,0
3468TRM2212	1/2"	13	M22x1,5	10,0	16	45,0	17,0	20,5	27	77,0
3468TRM2412	1/2"	13	M24x1,5	10,0	18	47,0	18,0	20,5	30	99,0
3468TRM2458	5/8"	16	M24x1,5	13,5	18	55,0	18,0	24,0	30	97,0
3468TRM3034	3/4"	20	M30x1,5	16,0	22	62,0	18,5	27,0	36	137,0
3468TRM361	1"	25	M36x1,5	22,0	28	71,3	21,0	36,5	42	249,0

The barb connector 3468 can be combined with our yellow brass compression fittings range.  
Refer to Ød in order to chose the right combination.

**3468:** For use with our ASR, ASR-HH and ASR-PU tubes

**ASR**

Push-lock hose ASR



CODE	DN	ID (mm)	OD (mm)	MIN. BENDING RADIUS (mm)	MAX WORKING PRESSURE AT 20 °C (Bar)	g/m	Q.TY FOR ROLL (m)
ASR06	1/4"	6	6,5 <sup>+0,4</sup> <sub>-0,3</sub>	12,0 - 13,0	45	16	140
ASR10	3/8"	10	9,7 ±0,4	14,8 - 16,0	75	16	170
ASR13	1/2"	13	13,0 ±0,5	18,5 - 20,0	90	16	260
ASR16	5/8"	16	16,0 <sup>+0,7</sup> <sub>-0,3</sub>	23,4 - 25,0	115	16	340
ASR20	3/4"	20	19,3 ±0,5	26,0 - 28,0	135	16	420
ASR25	1"	25	25,6 ±0,5	34,0 - 36,0	165	16	640

\* Blue, Red and Green: available on demand and min. quantity

DN	Black	* Blue	* Red	* Green
1/4" 6	ASR06NE	ASR06BL	ASR06RO	ASR06VD
3/8" 10	ASR10NE	ASR10BL	ASR10RO	ASR10VD
1/2" 13	ASR13NE	ASR13BL	ASR13RO	ASR13VD
5/8" 16	ASR16NE	ASR16BL	ASR16RO	ASR16VD
3/4" 20	ASR20NE	ASR20BL	ASR20RO	ASR20VD
1" 25	ASR25NE	ASR25BL	ASR25RO	ASR25VD

Full technical data sheet available on page 769



## ASR-HH

Push-lock hose ASR-HH



CODE	DN		ID (mm)	OD (mm)	MIN. BENDING RADIUS (mm)	MAX WORKING PRESSURE AT 20°C (Bar)	g/m	Q.TY FOR ROLL (m)
ASR-HH06	1/4"	6	6,5 <sup>+0,4</sup> <sub>-0,3</sub>	12,0 - 13,0	45	14	125	40
ASR-HH10	3/8"	10	9,7 <sup>±0,4</sup>	14,8 - 16,0	75	14	150	40
ASR-HH13	1/2"	13	13,0 <sup>±0,5</sup>	18,5 - 20,0	90	14	235	40
ASR-HH16	5/8"	16	16,0 <sup>+0,7</sup> <sub>-0,3</sub>	23,4 - 25,0	115	14	350	40

\* available on demand and min. quantity

DN		Blue	Red
1/4"	6	* ASR-HH06BL	ASR-HH06RO
3/8"	10	ASR-HH10BL	ASR-HH10RO
1/2"	13	ASR-HH13BL	ASR-HH13RO
5/8"	16	ASR-HH16BL	ASR-HH16RO

Full technical data sheet available on page 770

## ASR-PU

Push-lock hose ASR-PU



CODE	DN		ID (mm)	OD (mm)	MIN. BENDING RADIUS (mm)	WORKING PRESSURE AT 20°C (Bar)	NEGATIVE PRESSURE (Bar)	g/m
ASR-PU06	1/4"	6	6,4	13	25	13	0,8	110
ASR-PU10	3/8"	10	9,5	16	60	13	0,8	154
ASR-PU13	1/2"	13	12,5	19	75	13	0,8	218
ASR-PU16	5/8"	16	16,5	23	125	12	0,8	280
ASR-PU20	3/4"	20	19,5	27	150	10	0,8	325

\* Light blue, Red and Green: available on demand and min. quantity

DN		Black	* Light blue	* Red	* Green
1/4"	6	ASR-PU06NE	ASR-PU06AZ	ASR-PU06RO	ASR-PU06VD
3/8"	10	ASR-PU10NE	ASR-PU10AZ	ASR-PU10RO	ASR-PU10VD
1/2"	13	ASR-PU13NE	ASR-PU13AZ	ASR-PU13RO	ASR-PU13VD
5/8"	16	ASR-PU16NE	ASR-PU16AZ	ASR-PU16RO	ASR-PU16VD
3/4"	20	ASR-PU20NE	ASR-PU20AZ	ASR-PU20RO	ASR-PU20VD

Full technical data sheet available on page 771

