

**3400**

Male connector BSPT threaded

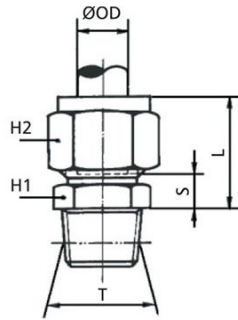

CODE	T	ØOD	L	S	H1	H2	GR.
3400TR184	R1/8"	4	17,0	7,0	10	10	-
3400TR144	R1/4"	4	20,0	9,5	14	10	-
3400TR186	R1/8"	6	18,0	7,5	11	13	18,0
3400TR146	R1/4"	6	18,0	7,5	14	13	25,0
3400TR386	R3/8"	6	19,0	8,5	17	13	-
3400TR188	R1/8"	8	19,5	7,0	13	14	22,0
3400TR148	R1/4"	8	19,5	7,0	14	14	27,0
3400TR388	R3/8"	8	20,5	8,0	17	14	33,0
3400TR1810	R1/8"	10	24,0	9,0	17	19	-
3400TR1410	R1/4"	10	24,0	9,0	17	19	48,0
3400TR3810	R3/8"	10	24,0	9,0	17	19	49,0
3400TR1210	R1/2"	10	25,0	10,0	22	19	67,0
3400TR1412	R1/4"	12	24,0	9,0	19	22	-
3400TR3812	R3/8"	12	24,0	9,0	19	22	-
3400TR1212	R1/2"	12	25,0	10,0	22	22	-
3400TR1414	R1/4"	14	26,0	10,5	22	24	-
3400TR3814	R3/8"	14	25,0	8,0	22	24	70,0
3400TR1214	R1/2"	14	26,0	9,0	22	24	80,0
3400TR1216	R1/2"	16	27,0	9,5	24	27	101,0
3400TR3416	R3/4"	16	28,0	10,5	27	27	-
3400TR1218	R1/2"	18	30,0	10,5	27	30	132,0
3400TR3418	R3/4"	18	30,0	10,5	27	30	143,0
3400TR1220	R1/2"	20	32,0	11,0	30	32	-
3400TR3420	R3/4"	20	32,0	11,0	30	32	-
3400TR1222	R1/2"	22	33,0	11,0	32	36	-
3400TR3422	R3/4"	22	33,0	11,0	32	36	195,0
3400TR122	R1"	22	33,0	11,0	36	36	225,0
3400TR128	R1"	28	36,0	11,0	41	42	-

