

**FLUID-10S-M**

Safety male quick coupler DN 5,5

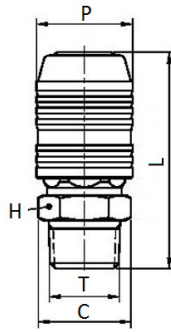

CODE	T	P	L	C	H
FLUID-10S-M1/4	R1/4"	25,6	55,7	19,0	17
FLUID-10S-M3/8	R3/8"	25,6	56,7	19,0	17
FLUID-10S-M1/2	R1/2"	25,6	61,2	24,6	22
FLUID-10S-M1/2G	G1/2"	26,6	61,2	24,6	24

**FLUID-10S-H**

Safety female quick coupler DN 5,5

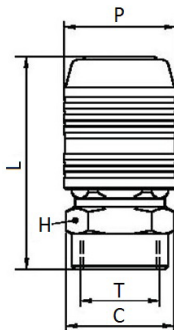

CODE	T	P	L	C	H
FLUID-10S-H1/4	G1/4"	25,6	53,7	21,5	19
FLUID-10S-H3/8	G3/8"	25,6	55,2	24,6	22
FLUID-10S-H1/2	G1/2"	25,6	59,4	27,5	25

**FLUID-10S-E**

Safety quick coupler with barb connector DN 5,5

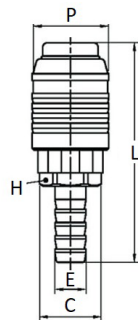

CODE	E	P	L	C	H
FLUID-10S-E6	7,2	26,6	63,2	21,5	19
FLUID-10S-E8	9,2	25,6	63,2	19	17
FLUID-10S-E10	11,2	25,6	67,2	19	17
FLUID-10S-E12	13,2	26,6	72,2	21,5	19
FLUID-10S-E13	13,8	26,6	72,2	21,5	19

**FLUID-10S-PM**

Safety joint push-on fitting DN 5,5

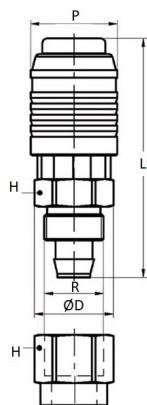

CODE	Ø TUBE	ØD	R	ØP	L	H
FLUID-10S-PM08	8X12	21,3	M16X1	26,6	64,7	19
FLUID-10S-PM10	10X15	24,3	M20X1	26,6	69,5	22

To used with PU-PVC

